



9a Guildford Street, Luton, LU1 2NQ
£900 Per month

- Exclusive to PR Property
- Modern fitted kitchen and bathroom
- Town centre amenities on the doorstep

- Available to move in June 2026
- Gas central heating (Gas Safe Certified)
- Secure entry access

- modern finish throughout
- Located beside Luton train station
- One double bedroom

Exclusive to PR Property this modern one-bedroom flat on Guildford Street offers stylish, nicely decorated accommodation right in the heart of Luton town center. Perfectly located next to Luton train station, this home is ideal for commuters and those seeking easy access to shopping, restaurants and local services. The flat features a bright open plan layout, a modern fitted kitchen, and gas central heating for year-round comfort. Ready to move in immediately, this is a superb opportunity for anyone wanting convenience and modern living in a prime central location.

HALL

Door to Storage cupboard, open plan to Fitted Kitchen & seating area.

FITTED KITCHEN 9'4" X 7'7" (2.84 X 2.31)

Fitted with a matching range of base and eye level units with worktop space over, stainless steel sink with tiled splashbacks, fridge, washing machine and cooker, double glazed window to side, door to:

LIVING ROOM 11'10" X 11'9" (3.61 X 3.58)

Double glazed window to front, radiator.

BEDROOM 1 12'9" X 8'8" (3.89 X 2.64)

Obscure double glazed window to rear, radiator.

BATHROOM

Fitted with three piece suite comprising shower, pedestal wash hand basin and close coupled WC, extractor fan, obscure double glazed window to rear, radiator.

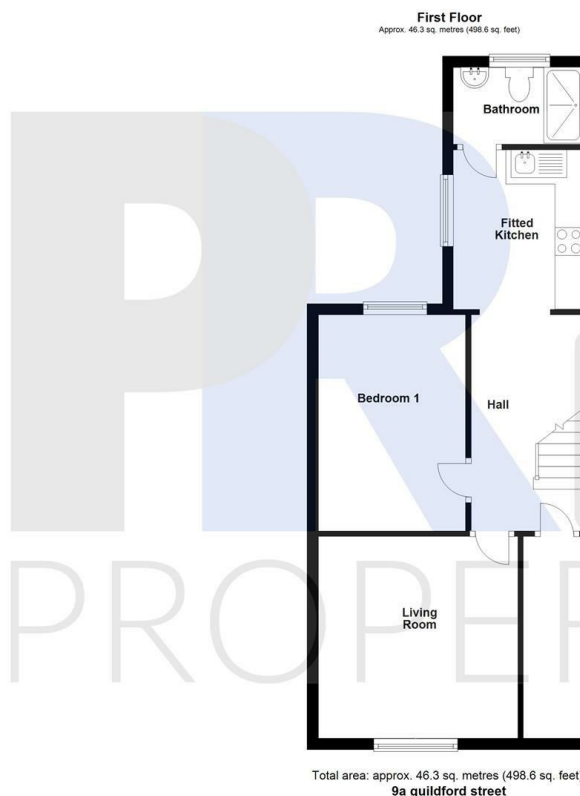

Energy Efficiency Rating		
	Current	Potential
Very energy efficient - lower running costs		
(92 plus) A		
(81-91) B		
(69-80) C		
(55-68) D		
(39-54) E		
(21-38) F		
(1-20) G		
Not energy efficient - higher running costs		
	63	75
England & Wales	EU Directive 2002/91/EC	